

Brass Earth Block



Product Type:
Brass Earth Block

Standards:
RoHS Compliant

Specification:

Housing: Brass
Screw: 2BA brass screws
Finish: Nickel Plated

Application:

Brass Earth Block used to secure and/or terminate wires. Consists of several individual terminals arranged in a long strip and supplied with slot head brass screws.

Drawing:

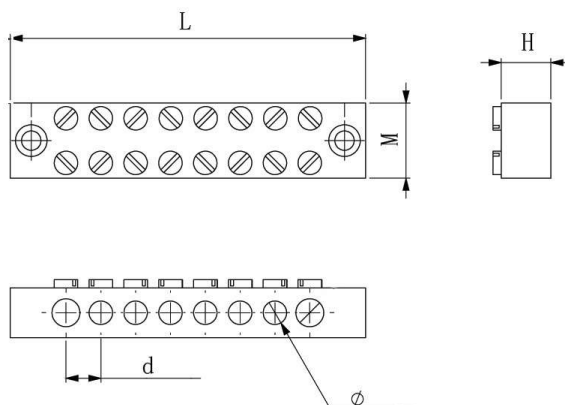

CODE	WAYS	Pack Quantity	DIMENSIONS (MM)				
			L	M	Φ	d	H
ETB4W	4	5	51.2	18.5	Φ5.7	8.5	12.2
ETB8W	8	5	87.7	18.5	Φ5.7	9.25	12.2